

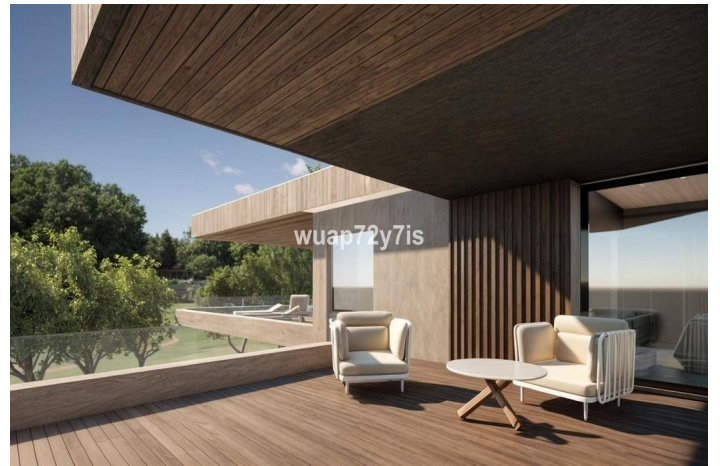

# Detached Villa for sale in Estepona, Estepona

**1,850,000 €**

Reference: R4964905 Bedrooms: 4 Bathrooms: 3 Plot Size: 627m<sup>2</sup> Build Size: 232m<sup>2</sup> Terrace: 45m<sup>2</sup>





---

## Costa del Sol, Estepona

Project for Detached Villa with Stunning Sea Views in Estepona

Welcome to your dream home in the sought-after Arena Beach area of Estepona. This luxurious single-family villa combines contemporary design with impeccable functionality, making it perfect for those seeking a modern lifestyle in a serene coastal location.

### Key Features:

**Prime Location:** Situated in Arena Beach, this villa is just a short distance from the beach, offering both tranquility and convenience.

**Spacious Plot:** The property sits on a generous 627 m<sup>2</sup> plot, offering ample space for relaxation and recreation.

**Elegant Layout:** The villa boasts a two-story layout with a total built area of 232 m<sup>2</sup>. The design maximizes natural light and seamless indoor-outdoor flow.

### Sophisticated Interiors:

Ground floor includes an open-plan kitchen and dining area, a stylish main living room, a secondary lounge, an office, and a utility bathroom/laundry.

The first floor features a master suite with a private bathroom and dressing room, two additional spacious bedrooms, and expansive terraces for panoramic views.

**Outdoor Oasis:** Enjoy a terrace overlooking the stunning pool and a Jacuzzi. Perfect for entertaining or unwinding under the Mediterranean sun.

**Private Parking:** A semi-covered parking area and an easy-access ramp add to the convenience.

**Eco-Friendly Design:** The home is designed with urban zoning compliance, maintaining a 3-meter setback from private boundaries for added privacy.

This villa offers a harmonious blend of luxurious comfort and cutting-edge design.



## Features:

### Features

Covered Terrace  
Private Terrace  
Storage Room  
Marble Flooring

### Views

Sea  
Panoramic  
Garden  
Pool

### Pool

Private

### Parking

Private  
Covered

### Orientation

South

### Setting

Urbanisation  
Close To Sea  
Close To Shops  
Close To Town  
Close To Schools

### Garden

Private

### Category

Luxury  
Off Plan  
New Development

### Climate Control

Pre Installed A/C  
Cold A/C  
Hot A/C

### Condition

New Construction

### Security

Alarm System